



B.N.C.TOOLING Co.,Ltd.

BNCTOOLING.COM
BNCTOOLINGSHOP.COM

69/90 Hatairat Rd., Minburi ,Minburi Bangkok (Thailand) 10510

SCHMIDT
control instruments

Tension Meter

10 Tension ranges available
from 10 - 50 cN up to 5 - 20 daN

Tension Meter DX2S

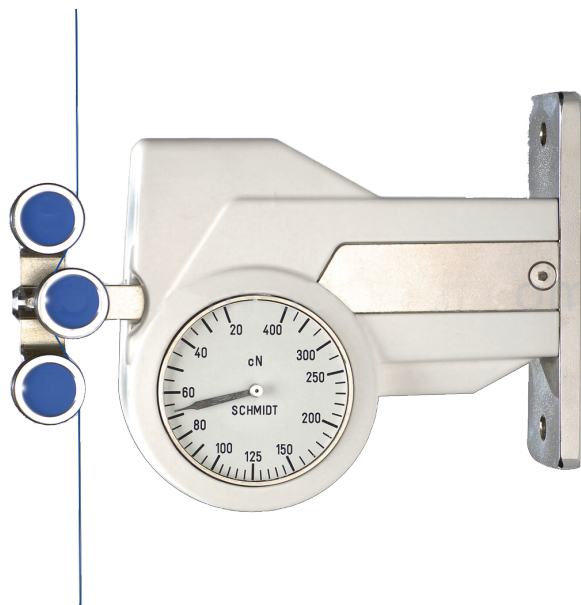

Specifications

Calibration:	According to SCHMIDT factory procedure
Accuracy:	± 1 % full scale or ± 1 graduation on scale
Scale diameter:	41 mm
Temperature range:	10 – 45 °C
Air humidity:	85 % RH, max.
Housing material:	Die-cast aluminium
Dimensions:	See dimensions
Weight, net (gross):	Up to model DX2S-10K approx. 400 g (800 g) DX2S-20K approx. 500 g (1000 g)

Special Features

- The analog display shows changing and fluctuating tensions fast and enables an optimal process adjustment
- Easy online mounting with 2 screws
- Tension meter DX2S is available with custom-built configurations and special calibrations

Note: Tension meter DX2S do not include a filament guide and material thickness compensator.

Standard Features

- Everything in operator's view:
 - the guide rollers
 - the measured material
 - the readings
- Ball-bearing mounted, V-grooved guide rollers
- Each instrument is individually calibrated for highest accuracy
- 41 mm Ø scale
- Tension meter with rugged aluminium housing
- Certificate of Compliance with the order 2.1 according EN 10204 is included
- Optionally available: Inspection Certificate 3.1 according EN 10204 with calibration report

Calibration to customized material:

If process material differs significantly from the SCHMIDT calibration material in diameter, rigidity or shape, special calibration using customer supplied samples is recommended. For this purpose a material sample of about 5 m should be supplied.



B.N.C.TOOLING Co.,Ltd.

BNCTOOLING.COM
BNCTOOLINGSHOP.COM

69/90 Hatairat Rd., Minburi ,Minburi Bangkok (Thailand) 10510

SCHMIDT
control instruments

Tension Meter

Dimensions Tension Meter Model DX2S

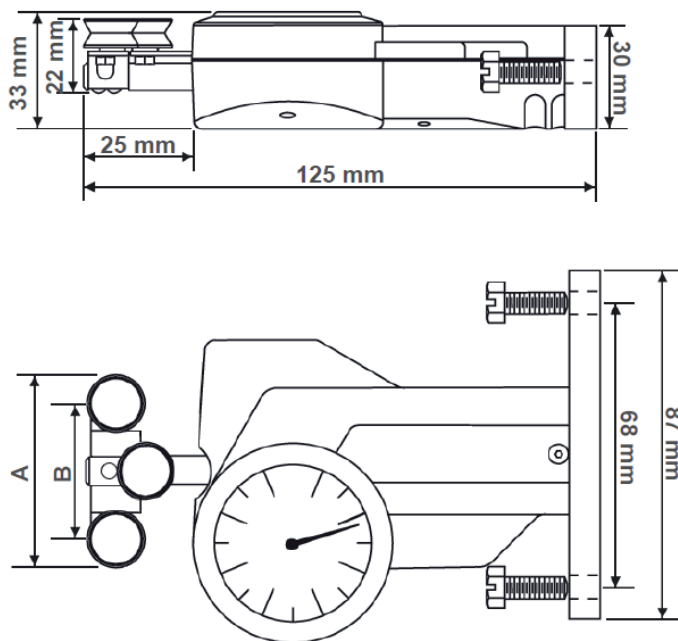

Available Models

Model	Tension Range	Measuring Head Width*	SCHMIDT Calibration Material**
DX2S-50	10 – 50 cN	54 mm	PA: 0.12 mm Ø
DX2S-120	20 – 120 cN	54 mm	PA: 0.12 mm Ø
DX2S-200	20 – 200 cN	54 mm	PA: 0.12 mm Ø
DX2S-400	20 – 400 cN	54 mm	PA: 0.20 mm Ø
DX2S-1000	50 – 1000 cN	54 mm	PA: 0.30 mm Ø
DX2S-2000	200 – 2000 cN	116 mm	PA: 0.50 mm Ø
DX2S-5000	400 – 5000 cN	116 mm	PA: 0.80 mm Ø
DX2S-8000	1000 – 8000 cN	116 mm	PA: 1.00 mm Ø
DX2S-10K	2.5 – 10 daN	116 mm	PA: 1.00 mm Ø
DX2S-20K	5 – 20 daN	216 mm	PA: 1.50 mm Ø